



**COMMERCIAL TYPE B GAS VENT
MODEL E/V 10" – 30"**
www.eccomfg.com

INDEX

DESCRIPTION	90
E/V PIPE AND FITTINGS	
10" Model	91
12" Model	91 – 92
14" Model	92
16" Model	93
18" Model	93
20" Model	94
22" Model	94
24" Model	95
26" Model	95
28" Model	96
30" Model	96
TECHNICAL DATA	97 – 104



ECCO is proud to be a member of:



ASHRAE
American Society of
Heating, Refrigeration, and
Air Conditioning Engineers, Inc.
www.ashrae.com



HRAI
Heating, Refrigerating
and Air Conditioning
Institute of Canada
www.hrai.ca



HARDI
Heating, Airconditioning &
Refrigeration Distributors
International
www.hardinet.org



SMACNA
Sheet Metal & Air
Conditioning Contractors
National Association Inc.
www.smacna.org



SPIDA
Spiral Duct
Manufacturers
Association
www.spida.org



GAS VENT 10" – 30"

CERTIFICATION

- Listed by Underwriters Laboratories of Canada, File Number CMH 609.
- Listed by Underwriters Laboratories Inc., U.S.A., File Number MH 12111.



APPLICATIONS

- ECCO Type B Gas Vent is a prefabricated metal vent to be used for venting approved gas burning equipment as specified by the authorities having jurisdiction and not for incinerators or heating appliances requiring connection to chimneys. Temperatures at the outlet of the appliance draft hood shall not exceed 470°F (245°C).

MATERIALS

- The vent consists of factory made parts, designed to be assembled without requiring field fabrication.
- The inner conduit and Rain Caps consist of an aluminum alloy of Type 1100 or Type 3003.
- The outer casing consists of Galvalume steel conforming to the latest revision of ASTM A792, AZ150.
- Vent accessories consist of Galvanized steel conforming to the latest revision of ASTM A653.

INSTALLATION

- Every 30 feet of vent height requires at least one Support Plate and Ring Assembly.
- The vent shall extend at least 2 feet above the highest point where it passes through a flat roof and at least 2 feet higher than any part of the building within a horizontal distance of 10 feet.
- The vent shall extend at least 2 feet above the highest point where it passes through a pitch roof of 9/12 pitch or less and at least 2 feet higher than any other obstruction within a horizontal distance of 10 feet.
- Clearance to combustible materials shall not be less than 1 inch.
- Except for installation in single and two family dwellings, gas vents which extend through any storey above that on which the connected appliance is located are to be provided with enclosures having a fire resistance rating equal to, or greater than, that of the floor or roof assemblies through which they pass.
- To ensure a safe and proper installation, install the vent using all the parts as specified in the *Installation Instructions*.
- Bird screens may be susceptible to blockage through freezing moisture in areas of low ambient temperature. Consult authority having jurisdiction.

DIE-FORMED COUPLINGS

- integrates the inner and outer pipe as one unit
- ensures consistent quality and fit

PRESTAMPED SCREW HOLES

- no drilling
- easy and quick assembly
- a positive and strong lock

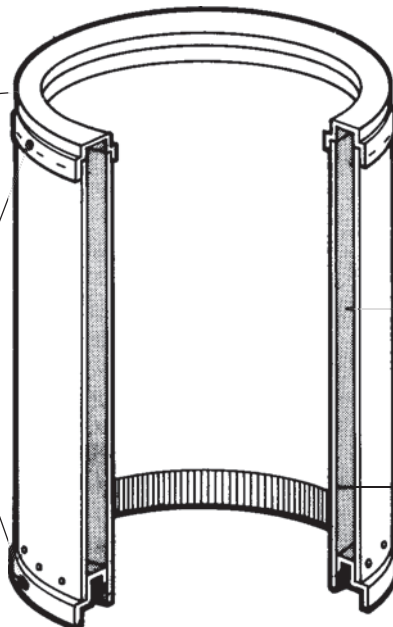

OUTSIDE CASING OF GALVALUME OR GALVANIZED STEEL

- provides strength and durability

1" INSULATING AIR SPACE

- eliminates condensation, while keeping the outer casing cool

INSIDE CONDUIT OF ALUMINUM

- resists corrosion

– E.&O.E. – May not be in stock at all branches, if so please allow 10 days for delivery. –
 – All Prices F.O.B. Our Warehouse – Subject to Change Without Notice – All Taxes Extra –



GAS VENT 10" – 30"

ECCO
Manufactured
Products

10" MODEL E/V TYPE B GAS VENT PIPE AND FITTINGS

STOCK #	MODEL	DESCRIPTION	WT/100	PRICE/EA
231004	1012VP	10" x 12" B-Vent Pipe	400	\$ 93.75
231003	1018VP	10" x 18" B-Vent Pipe	520	100.58
231052	1024VP	10" x 24" B-Vent Pipe	630	123.48
231002	1036VP	10" x 36" B-Vent Pipe	950	132.99
231001	1060VP	10" x 60" B-Vent Pipe	1600	190.91
231026	1018VPA	10" x 18" B-Vent Pipe – Adjustable	520	269.44
231006	10RC	10" Rain Cap	280	148.57
231007	10SC	10" Storm Collar	50	17.96
231008	10AF	10" Adjustable Flashing 1/12 – 7/12 Pitch	410	73.05
231009	10FF	10" Flat Flashing	520	86.43
231010	10FS	10" Fire Stop Spacer	150	23.62
231011	10SWT	10" x 10" x 10" Single Wall Tee	500	121.50
231012	10DWT	10" x 10" x 10" Double Wall Tee	700	230.20
231031	10DWW	10" x 10" x 10" Double Wall Wye	450	393.28
571026	10PTC	10" Plug/Tee Cap Spun Galvanized	105	22.69
231013	1045EL	10" x 45° Double Wall Elbow	400	146.28
231014	1090EL	10" x 90° Double Wall Elbow	670	200.16
231015	10DHC	10" Draft Hood Connector	180	66.00
231017	10SP	10" Support Plate	230	30.98
231018	10SR	10" Support Ring	75	16.12

Note: For Technical Data see end of section.

12" MODEL E/V TYPE B GAS VENT PIPE AND FITTINGS

STOCK #	MODEL	DESCRIPTION	WT/100	PRICE/EA
231204	1212VP	12" x 12" B-Vent Pipe	490	\$ 115.17
231203	1218VP	12" x 18" B-Vent Pipe	640	118.99
231252	1224VP	12" x 24" B-Vent Pipe	900	139.32
231202	1236VP	12" x 36" B-Vent Pipe	1180	163.48
231226	1218VPA	12" x 18" B-Vent Pipe – Adjustable	640	306.49
231206	12RC	12" Rain Cap	320	178.34
231207	12SC	12" Storm Collar	60	21.69
231208	12AF	12" Adjustable Flashing 1/12 – 7/12 Pitch	490	86.93
231209	12FF	12" Flat Flashing	580	113.06
231210	12FS	12" Fire Stop Spacer	180	27.79
231211	12SWT	12" x 12" x 12" Single Wall Tee	680	168.42
231212	12DWT	12" x 12" x 12" Double Wall Tee	980	282.60

(cont'd on next page)

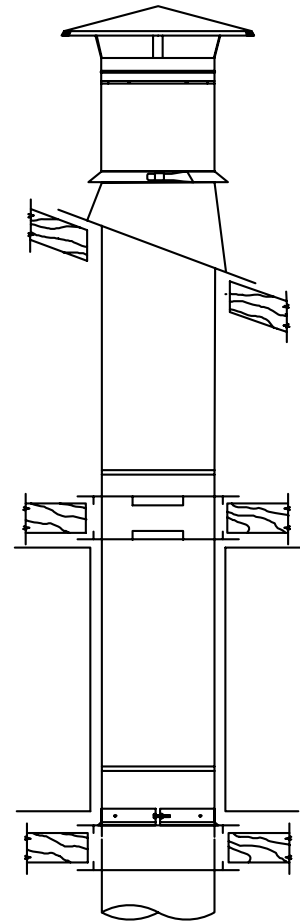

Type B Gas Vent Pipe and Fittings

– E.&O.E. – May not be in stock at all branches, if so please allow 10 days for delivery. –
– All Prices F.O.B. Our Warehouse – Subject to Change Without Notice – All Taxes Extra –



GAS VENT 10" – 30"

ECCO
Manufactured
Products

12" MODEL E/V TYPE B GAS VENT PIPE AND FITTINGS (cont'd)

STOCK #	MODEL	DESCRIPTION	WT/100	PRICE/EA
571226	12PTC	12" Plug/Tee Cap Spun Galvanized	140	\$ 26.12
231213	1245EL	12" × 45° Double Wall Elbow	520	165.82
231214	1290EL	12" × 90° Double Wall Elbow	800	251.40
231215	12DHC	12" Draft Hood Connector	230	79.07
231217	12SP	12" Support Plate	270	39.38
231218	12SR	12" Support Ring	80	20.56

Note: Custom B-Vent available upon request.

For Technical Data see end of section.

14" MODEL E/V TYPE B GAS VENT PIPE AND FITTINGS

STOCK #	MODEL	DESCRIPTION	WT/100	PRICE/EA
241404	1412VP	14" × 12" B-Vent Pipe —	570	\$ 141.79
241403	1418VP	14" × 18" B-Vent Pipe	740	165.10
241452	1424VP	14" × 24" B-Vent Pipe	900	180.63
241402	1436VP	14" × 36" B-Vent Pipe	1350	205.06
241426	1418VPA	14" × 18" B-Vent Pipe – Adjustable	740	334.68
241406	14RC	14" Rain Cap	380	271.11
241407	14SC	14" Storm Collar	100	31.61
241408	14AF	14" Adjustable Flashing 1/12 – 7/12 Pitch	580	140.58
241409	14FF	14" Flat Flashing	650	161.60
241410	14FS	14" Fire Stop Spacer	180	36.50
241411	14SWT	14"×14"×14" Single Wall Tee	930	246.05
241412	14DWT	14"×14"×14" Double Wall Tee	1190	468.08
571426	14PTC	14" Plug/Tee Cap Spun Galvanized	180	26.86
241413	1445EL	14" × 45° Double Wall Elbow	610	259.43
241415	14DHC	14" Draft Hood Connector	270	100.31
241417	14SP	14" Support Plate	310	51.86
241418	14SR	14" Support Ring	140	29.72

Note: For Technical Data see end of section.

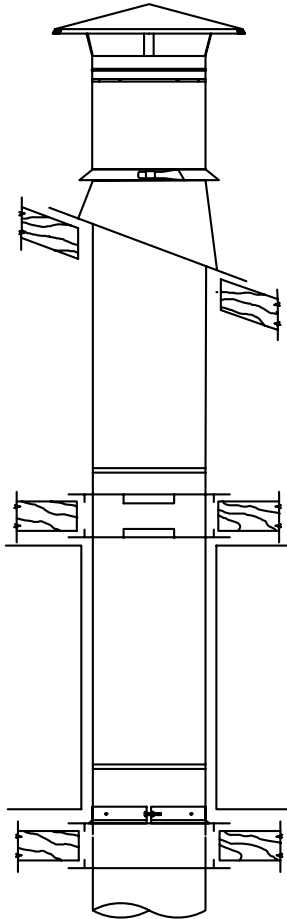

Type B Gas Vent Pipe and Fittings

– E.&O.E. – May not be in stock at all branches, if so please allow 10 days for delivery. –
– All Prices F.O.B. Our Warehouse – Subject to Change Without Notice – All Taxes Extra –



16" MODEL E/V TYPE B GAS VENT PIPE AND FITTINGS

STOCK #	MODEL	DESCRIPTION	WT/100	PRICE/EA
241604	1612VP	16" x 12" B-Vent Pipe	650	\$ 161.86
241603	1618VP	16" x 18" B-Vent Pipe	860	182.88
241652	1624VP	16" x 24" B-Vent Pipe	1000	197.52
241602	1636VP	16" x 36" B-Vent Pipe	1510	232.13
241626	1618VPA	16" x 18" B-Vent Pipe – Adjustable	860	364.27
241606	16RC	16" Rain Cap	430	312.10
241607	16SC	16" Storm Collar	110	33.45
241608	16AF	16" Adjustable Flashing 1/12 – 7/12 Pitch	670	170.58
241609	16FF	16" Flat Flashing	740	205.91
241610	16FS	16" Fire Stop Spacer	180	42.25
241611	16SWT	16" x 16" x 16" Single Wall Tee	1190	283.05
241612	16DWT	16" x 16" x 16" Double Wall Tee	1430	512.35
571626	16PTC	16" Plug/Tee Cap Spun Galvanized	220	27.58
241613	1645EL	16" x 45° Double Wall Elbow	760	351.16
241615	16DHC	16" Draft Hood Connector	300	109.83
241617	16SP	16" Support Plate	350	68.34
241618	16SR	16" Support Ring	140	32.37

Note: For Technical Data see end of section.

18" MODEL E/V TYPE B GAS VENT PIPE AND FITTINGS

STOCK #	MODEL	DESCRIPTION	WT/100	PRICE/EA
251804	1812VP	18" x 12" B-Vent Pipe	720	\$ 188.80
251803	1818VP	18" x 18" B-Vent Pipe	980	204.88
251852	1824VP	18" x 24" B-Vent Pipe	1130	248.39
251802	1836VP	18" x 36" B-Vent Pipe	1700	259.48
251826	1818VPA	18" x 18" B-Vent Pipe – Adjustable	910	441.95
251806	18RC	18" Rain Cap	540	408.05
251807	18SC	18" Storm Collar	110	32.87
251808	18AF	18" Adjustable Flashing 1/12 – 7/12 Pitch	730	247.31
251809	18FF	18" Flat Flashing	970	254.49
251810	18FS	18" Fire Stop Spacer	220	43.51
251811	18SWT	18" x 18" x 18" Single Wall Tee	1300	324.45
251812	18DWT	18" x 18" x 18" Double Wall Tee	1630	618.99
571826	18PTC	18" Plug/Tee Cap Spun Galvanized	270	34.06
251813	1845EL	18" x 45° Double Wall Elbow	850	468.08
251815	18DHC	18" Draft Hood Connector	340	113.46
251817	18SP	18" Support Plate	390	89.17
251818	18SR	18" Support Ring	160	44.72

Note: For Technical Data see end of section.

– E.&O.E. – May not be in stock at all branches, if so please allow 10 days for delivery. –
 – All Prices F.O.B. Our Warehouse – Subject to Change Without Notice – All Taxes Extra –

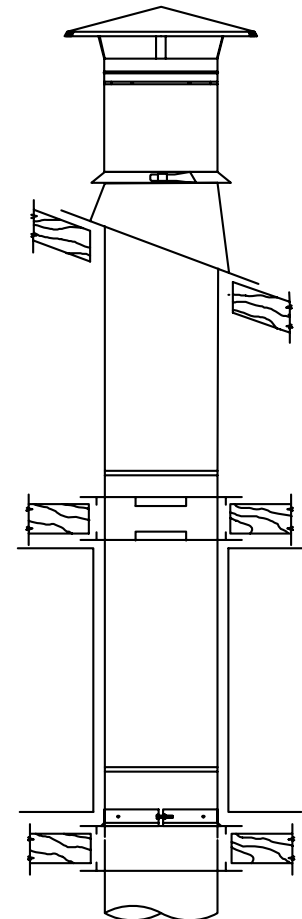

Type B Gas Vent Pipe and Fittings



GAS VENT 10" – 30"

ECCO
Manufactured
Products

20" MODEL E/V TYPE B GAS VENT PIPE AND FITTINGS

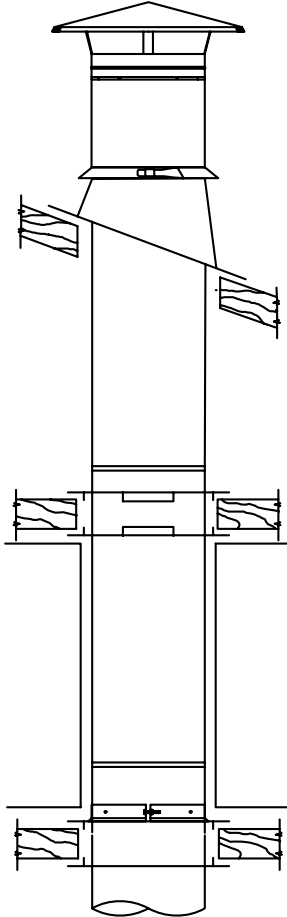

Type B Gas Vent Pipe and Fittings

STOCK #	MODEL	DESCRIPTION	WT/100	PRICE/EA
252004	2012VP	20" × 12" B-Vent Pipe	770	\$ 231.50
252003	2018VP	20" × 18" B-Vent Pipe	910	263.34
252052	2024VP	20" × 24" B-Vent Pipe	1210	295.62
252002	2036VP	20" × 36" B-Vent Pipe	1820	314.75
252026	2018VPA	20" × 18" B-Vent Pipe – Adjustable	980	498.30
252006	20RC	20" Rain Cap	750	550.11
252007	20SC	20" Storm Collar	150	41.44
252008	20AF	20" Adjustable Flashing 1/12 – 7/12 Pitch	820	251.40
252009	20FF	20" Flat Flashing	1030	294.32
252010	20FS	20" Fire Stop Spacer	260	50.74
252011	20SWT	20"×20"×20" Single Wall Tee	1530	324.54
252012	20DWT	20"×20"×20" Double Wall Tee	1910	693.53
572026	20PTC	20" Plug/Tee Cap Spun Galvanized	340	45.64
252013	2045EL	20" × 45° Double Wall Elbow	1070	600.49
252015	20DHC	20" Draft Hood Connector	310	134.43
252017	20SP	20" Support Plate	410	91.64
252018	20SR	20" Support Ring	170	35.43

Note: For Technical Data see end of section.

22" MODEL E/V TYPE B GAS VENT PIPE AND FITTINGS

STOCK #	MODEL	DESCRIPTION	WT/100	PRICE/EA
262204	2212VP	22" × 12" B-Vent Pipe	870	\$ 253.55
262203	2218VP	22" × 18" B-Vent Pipe	1040	282.65
262252	2224VP	22" × 24" B-Vent Pipe	1390	322.92
262202	2236VP	22" × 36" B-Vent Pipe	2080	340.16
262226	2218VPA	22" × 24" B-Vent Pipe – Adjustable	1040	553.30
262206	22RC	22" Rain Cap	860	597.44
262207	22SC	22" Storm Collar	160	43.24
262208	22AF	22" Adjustable Flashing 1/12 – 7/12 Pitch	920	293.96
262209	22FF	22" Flat Flashing	1120	351.07
262210	22FS	22" Fire Stop Spacer	250	60.17
262211	22SWT	22"×22"×22" Single Wall Tee	1820	358.53
262212	22DWT	22"×22"×22" Double Wall Tee	2280	752.66
572226	22PTC	22" Plug/Tee Cap Spun Galvanized	400	73.20
262213	2245EL	22" × 45° Double Wall Elbow	1190	712.02
262215	22DHC	22" Draft Hood Connector	350	172.64
262217	22SP	22" Support Plate	590	126.48
262218	22SR	22" Support Ring	180	37.94

Note: For Technical Data see end of section.

– E.&O.E. – May not be in stock at all branches, if so please allow 10 days for delivery. –
– All Prices F.O.B. Our Warehouse – Subject to Change Without Notice – All Taxes Extra –



24" MODEL E/V TYPE B GAS VENT PIPE AND FITTINGS

STOCK #	MODEL	DESCRIPTION	WT/100	PRICE/EA
262404	2412VP	24" x 12" B-Vent Pipe	940	\$ 288.87
262403	2418VP	24" x 18" B-Vent Pipe	1270	312.23
262452	2424VP	24" x 24" B-Vent Pipe	1470	356.96
262402	2436VP	24" x 36" B-Vent Pipe	2200	378.69
262426	2418VPA	24" x 18" B-Vent Pipe – Adjustable	1270	603.46
262406	24RC	24" Rain Cap	980	713.78
262407	24SC	24" Storm Collar	160	47.82
262408	24AF	24" Adjustable Flashing 1/12 – 7/12 Pitch	1070	351.75
262409	24FF	24" Flat Flashing	1180	399.61
262410	24FS	24" Fire Stop Spacer	280	59.58
262411	24SWT	24"x24"x24" Single Wall Tee	2160	378.78
262412	24DWT	24"x24"x24" Double Wall Tee	2700	939.22
572426	24PTC	24" Plug/Tee Cap Spun Galvanized	460	82.97
262413	2445EL	24" x 45° Double Wall Elbow	1220	854.58
262415	24DHC	24" Draft Hood Connector	370	170.89
262417	24SP	24" Support Plate	670	134.03
262418	24SR	24" Support Ring	190	48.04

Note: For Technical Data see end of section.

26" MODEL E/V TYPE B GAS VENT PIPE AND FITTINGS

STOCK #	MODEL	DESCRIPTION	WT/100	PRICE/EA
272603	2618VP	26" x 18" B-Vent Pipe	1830	\$ 587.92
272652	2624VP	26" x 24" B-Vent Pipe	2430	667.57
272602	2636VP	26" x 36" B-Vent Pipe	3650	780.95
272626	2618VPA	26" x 18" B-Vent Pipe – Adjustable	1830	903.84
272606	26RC	26" Rain Cap	1210	1,001.63
272607	26SC	26" Storm Collar	260	56.84
272609	26FF	26" Flat Flashing	1880	478.63
272610	26FS	26" Fire Stop Spacer	470	66.09
272612	26DWT	26"x26"x26" Double Wall Tee	4240	883.18
572626	26PTC	26" Plug/Tee Cap Galvanized	520	99.25
272613	2645EL	26" x 45° Double Wall Elbow	1490	1,049.22
272615	26DHC	26" Draft Hood Connector	430	226.39
272616	26SA	26" Support Assembly	440	173.94

Note: For Technical Data see end of section.

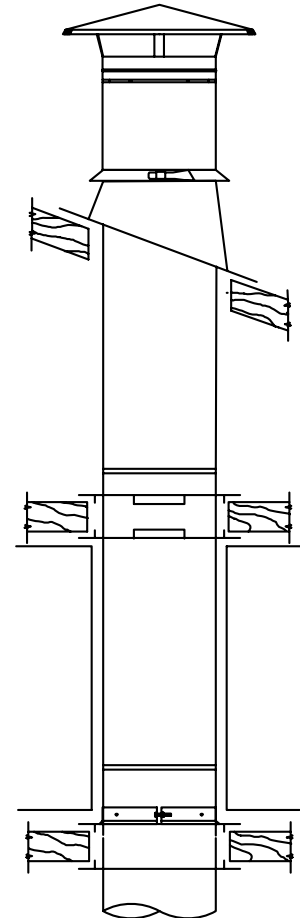

Type B Gas Vent Pipe and Fittings

– E.&O.E. – May not be in stock at all branches, if so please allow 10 days for delivery. –
 – All Prices F.O.B. Our Warehouse – Subject to Change Without Notice – All Taxes Extra –



GAS VENT 10" – 30"

ECCO
Manufactured
Products

28" MODEL E/V TYPE B GAS VENT PIPE AND FITTINGS

STOCK #	MODEL	DESCRIPTION	WT/100	PRICE/EA
272803	2818VP	28" × 18" B-Vent Pipe	1900	\$ 636.59
272852	2824VP	28" × 24" B-Vent Pipe	2530	714.31
272802	2836VP	28" × 36" B-Vent Pipe	3800	821.94
272826	2818VPA	28" × 18 B-Vent Pipe – Adjustable	1900	954.66
272806	28RC	28" Rain Cap	1310	1,054.39
272807	28SC	28" Storm Collar	290	68.97
272809	28FF	28" Flat Flashing	2030	553.35
272810	28FS	28" Fire Stop Spacer	380	72.96
272812	28DWT	28"×28"×28" Double Wall Tee	4400	949.23
572826	28PTC	28" Plug/Tee Cap Galvanized	580	112.43
272813	2845EL	28" × 45° Double Wall Elbow	1610	1,163.67
272815	28DHC	28" Draft Hood Connector	470	246.77
272816	28SA	28" Support Assembly	460	205.55

Note: For Technical Data see end of section.

30" MODEL E/V TYPE B GAS VENT PIPE AND FITTINGS

STOCK #	MODEL	DESCRIPTION	WT/100	PRICE/EA
283003	3018VP	30" × 18" B-Vent Pipe	2040	\$ 670.18
283052	3024VP	30" × 24" B-Vent Pipe	2710	755.49
283002	3036VP	30" × 36" B-Vent Pipe	4070	855.52
283026	3018VPA	30" × 18 B-Vent Pipe – Adjustable	2040	1,006.88
283006	30RC	30" Rain Cap	1430	1,187.16
283007	30SC	30" Storm Collar	310	72.38
283009	30FF	30" Flat Flashing	2260	646.83
283010	30FS	30" Fire Stop Spacer	420	77.99
283012	30DWT	30"×30"×30" Double Wall Tee	4730	1,002.80
573026	30PTC	30" Plug/Tee Cap Galvanized	640	140.43
283013	3045EL	30" × 45° Double Wall Elbow	1740	1,341.43
283015	30DHC	30" Draft Hood Connector	510	272.68
283016	30SA	30" Support Assembly	470	210.94

Note: For Technical Data see end of section.

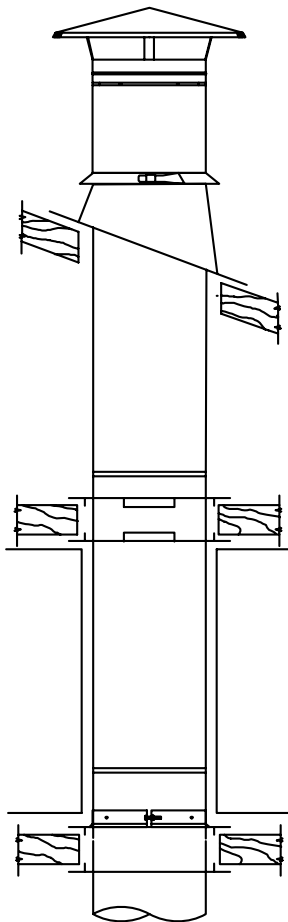

Type B Gas Vent Pipe and Fittings

– E.&O.E. – May not be in stock at all branches, if so please allow 10 days for delivery. –
– All Prices F.O.B. Our Warehouse – Subject to Change Without Notice – All Taxes Extra –



TECHNICAL DATA — MODEL E/V 10" – 24"

Vent Pipe — VP

SIZE A (")	B (")	LENGTH				
		60"	36"	24"	18"	12"
		C (")	C (")	C (")	C (")	C (")
10	12	58-3/4	34-3/4	22-3/4	16-3/4	10-3/4
12	14	N/A	34-3/4	22-3/4	16-3/4	10-3/4
14	16	N/A	34-3/4	22-3/4	16-3/4	10-3/4
16	18	N/A	34-3/4	22-3/4	16-3/4	10-3/4
18	20	N/A	34-3/4	22-3/4	16-3/4	10-3/4
20	22	N/A	34-3/4	22-3/4	16-3/4	10-3/4
22	24	N/A	34-3/4	22-3/4	16-3/4	10-3/4
24	26	N/A	34-3/4	22-3/4	16-3/4	10-3/4

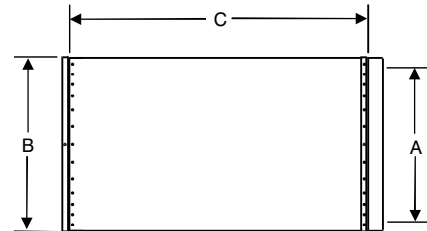

Note: Dimension C is installed length.

Vent Pipe Adjustable — VPA

SIZE A (")	B (")	C (")
10	12	18
12	14	18
14	16	18
16	18	18
18	20	18
20	22	18
22	24	18
24	26	18

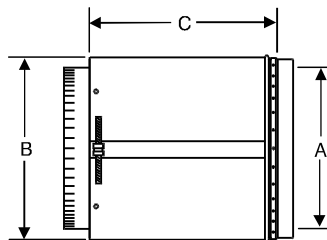

Note: Adjusts from 4" to 16"

Rain Cap — RC

SIZE A (")	B (")	C (")
10	8-1/4	20
12	8-1/4	22
14	11-1/4	28
16	12	31
18	13	34
20	14	37
22	15-1/2	40
24	16-1/4	43

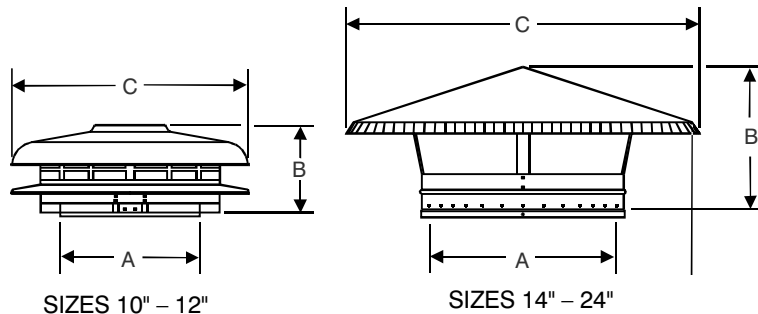

– E.&O.E. – May not be in stock at all branches, if so please allow 10 days for delivery. –
 – All Prices F.O.B. Our Warehouse – Subject to Change Without Notice – All Taxes Extra –



TECHNICAL DATA — MODEL E/V 10" – 24" (cont'd)

Storm Collar — SC

SIZE (")	A (")	B (")
10	14-3/4	12
12	16-3/4	14
14	20-1/4	16
16	22-1/4	18
18	24-1/4	20
20	26-1/4	22
22	28-1/4	24
24	30-1/4	26

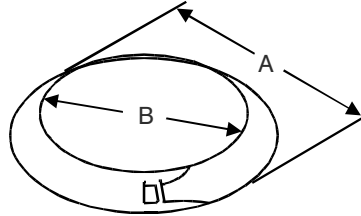

Adjustable Roof Flashing 1/12 – 7/12 Pitch — AF

SIZE (")	A (")	B (")	C (")	D (")
10	24 × 24	12	16-1/4	5
12	26 × 26	14	18-3/8	5
14	29 × 29	16	21	5
16	32 × 32	18	23-1/8	5
18	34 × 34	20	24	5
20	36 × 36	22	28	5
22	38 × 38	24	28-1/2	5
24	40 × 40	26	32-3/4	5

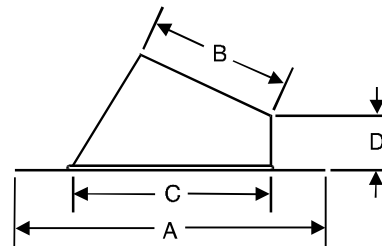

Flat Roof Flashing — FF

SIZE (")	A (")	B (")	C (")	D (")
10	24 × 24	12	16	10
12	26 × 26	14	18	10
14	28 × 28	16	19-3/4	10
16	30 × 30	18	22	10
18	36 × 36	20	23-3/4	10
20	38 × 38	22	25-3/4	10
22	40 × 40	24	30	10
24	42 × 42	26	31-3/4	10

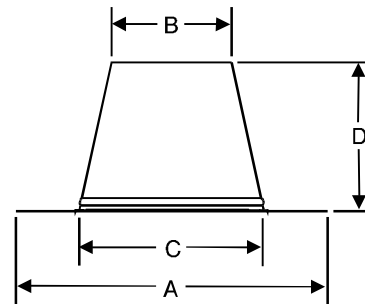

Note: All seams are soldered.

– E.&O.E. – May not be in stock at all branches, if so please allow 10 days for delivery. –
 – All Prices F.O.B. Our Warehouse – Subject to Change Without Notice – All Taxes Extra –

TECHNICAL DATA — MODEL E/V 10" – 24" (cont'd)

Fire Stop Spacer — FS

SIZE (")	A (")	B (")	C (")
10	18	12	14 × 14
12	20	14	16 × 16
14	22	16	18 × 18
16	24	18	20 × 20
18	26	20	22 × 22
20	28	22	24 × 24
22	30	24	26 × 26
24	32	26	28 × 28

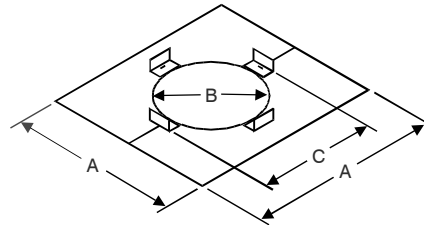

Note: Fire Stop Spacers are required above and below each floor and ceiling level penetrated by the vent.

Support Plate — SP

SIZE (")	A (")	B (")	C (")	D (")
10	18	12	14 × 14	4
12	20	14	16 × 16	4
14	22	16	18 × 18	3
16	24	18	20 × 20	3
18	26	20	22 × 22	3
20	28	22	24 × 24	3
22	30	24	26 × 26	3
24	32	26	28 × 28	3

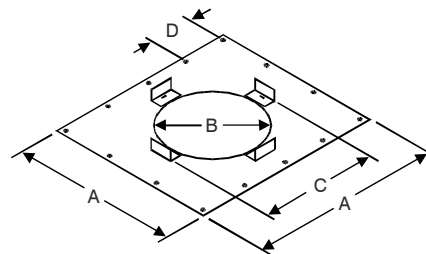

Note: Support Plate and Support Ring are required for every 30 feet of vent height.

Support Ring — SR

SIZE (")	A (")	B (")
10	2	12
12	2	14
14	2	16
16	2	18
18	2	20
20	2	22
22	2	24
24	2	26

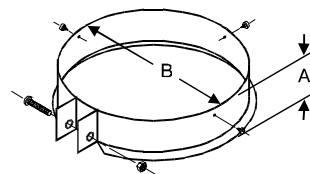

Note:

- Includes Sheet Metal Screws and Assembly Bolt for installation.
- Support Plate and Support Ring are required for every 30 feet of vent height.

- E.&O.E. - May not be in stock at all branches, if so please allow 10 days for delivery. -
 - All Prices F.O.B. Our Warehouse - Subject to Change Without Notice - All Taxes Extra -



TECHNICAL DATA — MODEL E/V 10" – 24" (cont'd)

45° Elbow — 45EL

SIZE A (")	B (")	C (")	D (")	E (")
10	12	5	3-7/8	3-1/2
12	14	5-3/8	4-1/4	3-1/2
14	16	5-7/8	4-5/8	3-1/2
16	18	6-1/4	5-1/8	3-1/2
18	20	6-5/8	5-1/2	3-1/2
20	22	7	5-7/8	3-1/2
22	24	7-1/2	6-3/8	3-1/2
24	26	7-7/8	6-3/4	3-1/2

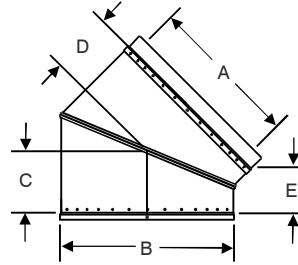

Offset

SIZE (")	A (")	B (")
10	6-1/4	15-1/8
12	6-7/8	16-1/2
14	7-1/2	18
16	8	19-3/8
18	8-5/8	20-3/4
20	9-1/4	22-1/4
22	9-3/4	23-5/8
24	10-3/8	25

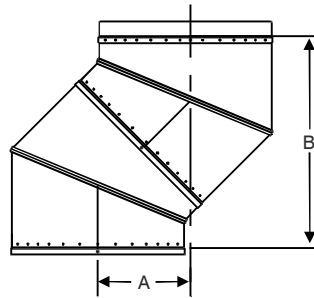

90° Elbow — 90EL

SIZE A (")	B (")	C (")	D (")
10	12	10-3/4	11-1/4
12	14	11-1/4	11-3/4
14	16	12-1/8	13-1/4
16	18	13-1/8	14-1/4
18	20	14-1/8	15-1/4
20	22	15-1/8	16-1/4
22	24	16-1/8	17-1/4
24	26	17-1/8	18-1/4

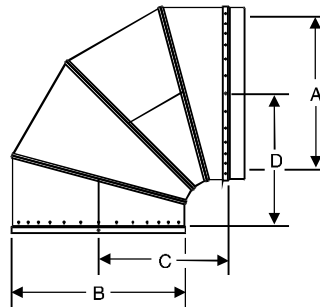

Note: For sizes 14" – 24" use two 45° Elbows to make 90°.

– E.&O.E. – May not be in stock at all branches, if so please allow 10 days for delivery. –
 – All Prices F.O.B. Our Warehouse – Subject to Change Without Notice – All Taxes Extra –



TECHNICAL DATA — MODEL E/V 10" – 24" (cont'd)

Double Wall Tee — DWT

SIZE A (")	B (")	C (")	D (")	E (")
10	12	16-3/4	10	9
12	14	18-3/4	11	10
14	16	22-3/4	12-1/2	12
16	18	24-3/4	13-1/2	13
18	20	26-3/4	14-1/2	14
20	22	28-3/4	15-1/2	15
22	24	30-3/4	16-1/2	16
24	26	32-3/4	17-1/2	17

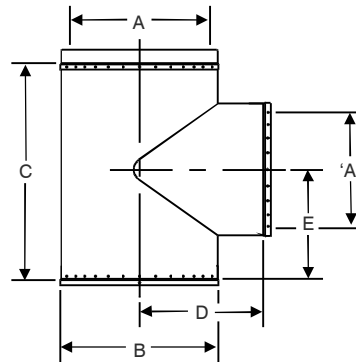

Note:

- Dimension C is installed length.
- Stub Dimension 'A' may vary according to customer requirements.
- Tee Cap not included.

Double Wall Wye — DWW

SIZE A (")	B (")	C (")	D (")
10	12	10	22
12	14	12	24
14	16	14	27
16	18	16	30
18	20	18	33
20	22	20	36
22	24	22	39
24	26	24	42

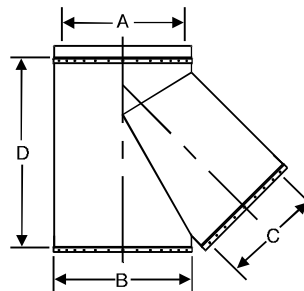

Note: Dimensions C and D may vary according to customer requirements.

Double Wall In increaser — INC

SIZE A (")	B (")	C (")	D (")
10	12	8	5-1/2
12	14	10	5-1/2
14	16	12	5-1/2
16	18	14	5-1/2
18	20	16	5-1/2
20	22	18	5-1/2
22	24	20	5-1/2
24	26	22	5-1/2

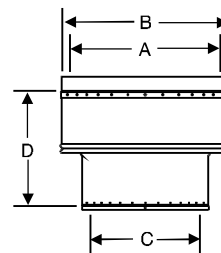

Note:

- Includes Sheet Metal Screws for installation.
- Dimensions C and D may vary according to customer requirements.

- E.&O.E. - May not be in stock at all branches, if so please allow 10 days for delivery. -
 - All Prices F.O.B. Our Warehouse - Subject to Change Without Notice - All Taxes Extra -



TECHNICAL DATA — MODEL E/V 10" – 24" (cont'd)

Draft Hood Connector — DHC

SIZE A (")	B (")	C (")	D (")
10	12	4	2-1/4
12	14	4	2-1/4
14	16	4	2-1/2
16	18	4	2-1/2
18	20	4	2-1/2
20	22	4	2-1/2
22	24	4	2-1/2
24	26	4	2-1/2

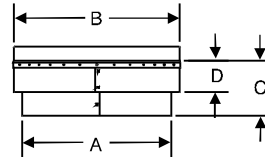

Single Wall Base Tee — SWT

SIZE A (")	B (")	C (")	D (")	E (")
10	12	13-7/8	8	7-1/2
12	14	16-3/4	9	9
14	16	18-3/4	11-1/2	10
16	18	22-3/4	12-1/2	12
18	20	24-3/4	13-1/2	13
20	22	26-3/4	14-1/2	14
22	24	28-3/4	15-1/2	15
24	26	30-3/4	16-1/2	16

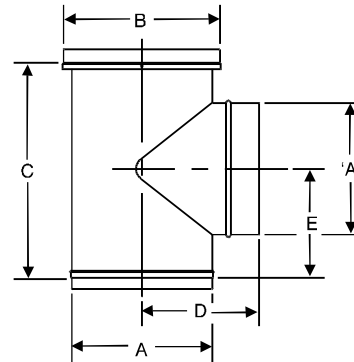

Note:

- Factory installed Tee Cap attached to bottom of Tee.
- Stub dimension 'A' may vary according to customer requirements.

Spun Tee Cap — TC

SIZE A (")	B (")
10	1-3/4
12	1-3/4
14	1-3/4
16	1-3/4
18	1-3/4
20	1-3/4
22	1-3/4
24	1-3/4

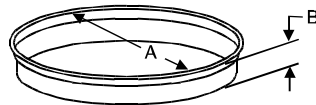

- E.&O.E. - May not be in stock at all branches, if so please allow 10 days for delivery. -
 - All Prices F.O.B. Our Warehouse - Subject to Change Without Notice - All Taxes Extra -



TECHNICAL DATA — MODEL E/V 26" – 30"

Vent Pipe — VP

SIZE A (")	B (")	LENGTH		
		36"	24"	18"
		C (")	C (")	C (")
26	28	35	23	17
28	30	35	23	17
30	32	35	23	17

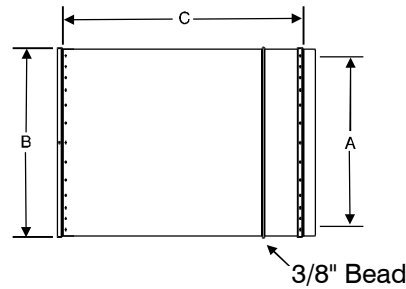

Note: Dimension C is installed length.

Rain Cap — RC

SIZE A (")	B (")	C (")
26	17-1/2	48
28	18-1/2	50
30	19-1/2	53

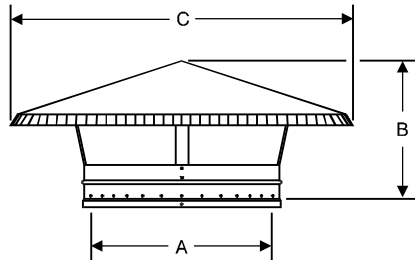

Storm Collar — SC

SIZE (")	A (")	B (")
26	32-1/4	28
28	34-1/4	30
30	36-1/4	32

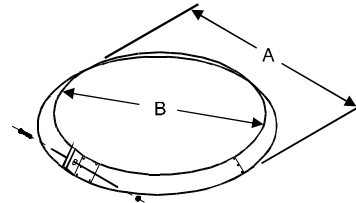

Note: Includes Assembly Bolts for installation.

Flat Roof Flashing — FF

SIZE (")	A (")	B (")	C (")	D (")
26	44 × 44	28	32	11-1/2
28	46 × 46	30	34	11-1/2
30	48 × 48	32	36	11-1/2

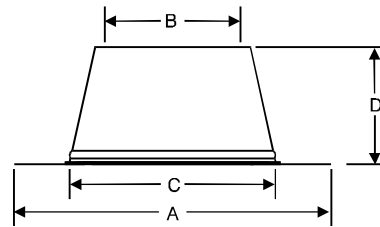

Note:

- All Flat Flashings are soldered.
- Adjustable flashing available on request.

Fire Stop Spacer — FS

SIZE (")	A (")	B (")	C (")
26	34-1/2	28	30 × 30
28	36-1/2	30	32 × 32
30	38-1/2	32	34 × 34

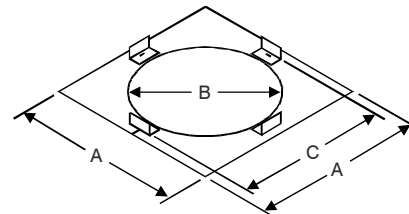

Note: Fire Stop spacers are required above and below each floor and ceiling level penetrated by the vent.

- E.&O.E. - May not be in stock at all branches, if so please allow 10 days for delivery. -
 - All Prices F.O.B. Our Warehouse - Subject to Change Without Notice - All Taxes Extra -



TECHNICAL DATA — MODEL E/V 26" – 30" (cont'd)

Support Assembly — SA

SIZE (")	A (")	B (")
26	34	28
28	34	30
30	34	32

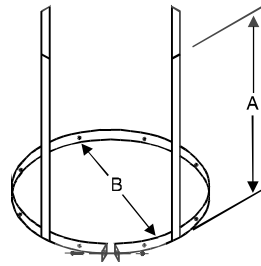

Note:

- Includes Sheet Metal Screws and Assembly Bolt for installation.
- Required for every 30 feet of vent height.

45° Elbow — 45EL

SIZE A (")	B (")	C (")	D (")	E (")
26	28	8-3/8	7-1/8	3-1/2
28	30	8-3/4	7-5/8	3-1/2
30	32	9-1/8	8	3-1/2

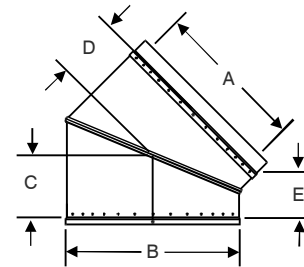

Double Wall Tee — DWT

SIZE A (")	B (")	C (")	D (")	E (")
26	28	35	20	17-3/4
28	30	35	21	17-3/4
30	32	35	22	17-3/4

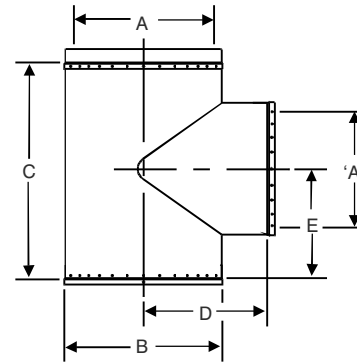

Note:

- Dimension C is installed length.
- Dimension 'A' may vary according to customer requirements.
- Tee Cap not included.

Draft Hood Connector — DHC

SIZE A (")	B (")	C (")	D (")
26	28	4	2-1/2
28	30	4	2-1/2
30	32	4	2-1/2

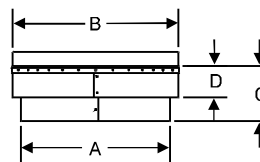

Tee Cap — TC

SIZE A (")	B (")
26	2
28	2
30	2

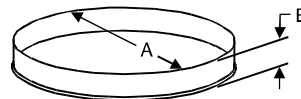

- E.&O.E. - May not be in stock at all branches, if so please allow 10 days for delivery. -
 - All Prices F.O.B. Our Warehouse - Subject to Change Without Notice - All Taxes Extra -