

WINE GUARDIAN® WINE CELLAR COOLING SYSTEMS
www.wineguardian.com

INDEX

DUCTABLE SYSTEM 3-3
 HUMIDIFIERS..... 3-4
 THROUGH-THE-WALL SYSTEM..... 3-2

This section contains product and technical information only.
 For additional information and product pricing please contact your local ECCO Supply Sales Branch.

ECCO is proud to be a member of:



ASHRAE
 American Society of Heating, Refrigerating, and Air-Conditioning Engineers, Inc.
www.ashrae.org



HRAI
 Heating, Refrigeration and Air Conditioning Institute of Canada
www.hrai.ca



HARDI
 Heating, Airconditioning & Refrigeration Distributors International
www.hardinet.org



SMACNA
 Sheet Metal and Air Conditioning Contractors' National Association
www.smacna.org



SPIDA
 Spiral Duct Manufacturers Association
www.spida.org

WINE GUARDIAN® WINE CELLAR COOLING SYSTEMS

www.wineguardian.com

THROUGH-THE-WALL SYSTEM

The Through-the-Wall (TTW) Wine Cooling System from Wine Guardian® is available in two capacities, each with a sleek, modern design to match the unique style of today's wine cellar. Perfect for small- to mid-sized cellars, this innovative system offers exceptional airflow and maintains optimal temperature and humidity with the quietest operation in its class.

Features

- Commercial-grade, corrosion-resistant components and an all-aluminum frame for long-term durability
- The only TTW system that controls temperature and displays both temperature and humidity
- Engineered for ideal airflow, including adjustable louvers for optimal cellar air circulation
- Quiet and efficient operation
- Can be mounted flush with the wall or racking
- EasyMount™ one-piece wall bracket and support frame included
- Certified to Underwriters Laboratories standards



Options

- Remote monitoring and sensing, alarm and communication capabilities
- Hot air discharge duct adapter kit
- Freestanding humidifier



Additional Standard Features

- Integrated condensate evaporation system
- Drain overflow connection
- Specially coated, corrosion-resistant cooling coil
- Power cord connections on both sides of system
- Environmentally friendly R-134a refrigerant

System Specifications*

MODEL	CAPACITY	WIDTH (")	DEPTH (")	HEIGHT (")	ELECTRICAL	WEIGHT (LBS)
TTW009**	850	14-1/4	25	15-7/8	115V/1PH/60Hz	60
TTW018**	1500	14-1/4	25	15-7/8	115V/1PH/60Hz	62

* Designed for 95°F max, 50° min condenser inlet. Sizing note: many variables affect proper unit sizing, including type of construction, insulation values, amount of glass, residential vs. commercial applications, etc. Proper unit size should only be determined by using the Wine Guardian sizing calculations.

**Direct replacement for most through-the-wall models.



Front View

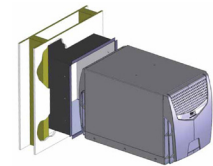

Side View
(with Easy Mount™)



Back View
(shown with optional duct adapter)

WINE GUARDIAN® WINE CELLAR COOLING SYSTEMS

www.wineguardian.com

DUCTABLE SYSTEM

Completely self-contained and made using the highest-grade materials, Wine Guardian® ductable systems are the most versatile cooling systems on the market. They provide optimal temperature and humidity control for both commercial and residential cellars with a design that allows for easy installation.

Many of the system's features and options are unique to the Wine Guardian brand, known around the world for superior performance and reliability in wine room conditioning. With Wine Guardian you can be assured you are creating the perfect environment for the preservation of your fine wine collection.

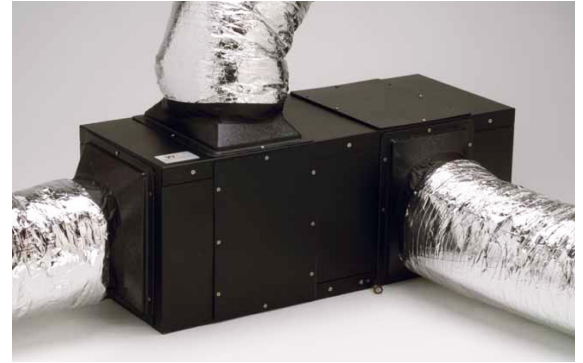

Features

- Multiple capacities for cellars of any size and configuration
- Lightweight, corrosion-resistant, all aluminum outer body for durability
- Completely self-contained design
- Multi-panel design for easy service access
- Multiple supply air openings for installation flexibility
- High static pressure fans for extended lengths of ductwork
- Cleanable filter on both condenser and evaporator coils
- Factory tested prior to shipment
- Certified to Underwriters Laboratories standards
- 24/7 factory service hotline support

Options

- Water-cooled system
- Low- and high-ambient protection
- Drip pad humidifier and humidistat (freestanding or integrated)
- Integral electric heat
- Duct kits and collars

Benefits of External Ducting

- Lower sound levels
- Virtually no vibration in the cellar
- Better air distribution and temperature control
- Flexibility in location and cellar design
- Ability to exhaust and/or recapture and redirect excess heat for energy conservation
- Easier to service

System Specifications*

MODEL	CAPACITY (CU FT)	WIDTH (")	DEPTH (")	HEIGHT (")	ELECTRICAL	WEIGHT (LBS)
1/4 TON	400 - 2000	35	14	14	115V/1PH/60Hz	77
1/2 TON	800 - 3200	39	22	14	115V/1PH/60Hz	123
1 TON	1200 - 6000	39	22	14	230V/1PH/60Hz	128
2 TON	2400 - 8500	43	22	18	230V/1PH/60Hz	199

*Sizing note: Many variables affect proper unit sizing, including type of construction, insulation values, amount of glass, residential vs. commercial applications, etc. Proper unit size should only be determined by using the Wine Guardian sizing calculations.



System shown with optional integrated humidifier



Side View



Water Cooled System (optional)

HUMIDIFIERS

Self-contained, freestanding Wine Guardian Humidifiers increase humidity levels within residential or commercial wine cellars. Prevents mold and degradation of the labels and glue if humidity is too high. Prevents corks from drying out and possible degradation of wine if the humidity is too low. Integrated humidifiers can be used with ductable Wine Guardian systems. Freestanding humidifiers can be used with ductable or Through-the-Wall Wine Guardian systems.

Features

- Drip pad-type humidification with removable, cleanable pad
- Humidifier can be mounted as a freestanding unit within the wine cellar
- Lightweight, corrosion-resistant, all-aluminum outer body
- Integral fan for air circulation
- Removable supply grille and drip pad access cover for easy service
- Completely self-contained design with cellar-mounted humidistat
- Factory tested prior to shipment
- Freestanding option plugs into any 115 volt electrical outlet

Maintenance of the Humidifier

A regular maintenance program prolongs the life of the humidifier and helps maintain proper humidity levels in the cellar. Frequency of cleaning and replacement of the drip pad depends on the inlet water conditions and the cleanliness of the cellar air. The drain system may also trap dust and dirt. When water no longer stays on the pad or mineral build-up has started to reduce airflow, the pad needs to be replaced.

For these reasons, it's suggested you check the drain on a monthly basis and confirm there is a steady flow of water while unit is in operation. Clean drain if needed. Also, check monthly for unusual noise or vibration, which could be a sign that the debris may be trapped and needs to be removed. Refer to your humidifier's installation operation and maintenance manual for step-by-step instructions on how to clean the humidifier and replace the evaporative drip pad.

Specifications (Freestanding model)

TYPE	REMOVABLE DRIP PAD WITH INTEGRAL FAN
Supply water temp of 60°F (gal/day)	1.6
Supply water temp of 90°F (gal/day)	3.5
Supply water temp of 120°F (gal/day)	5.1
Controls	Cellar-mounted digital humidistat
Power Requirements (V/P/H)	115/1/60 as freestanding, 24 volt, direct connected to WG



Freestanding Wine Guardian Humidifier (above)
Integrated humidifier on ductable system (left)

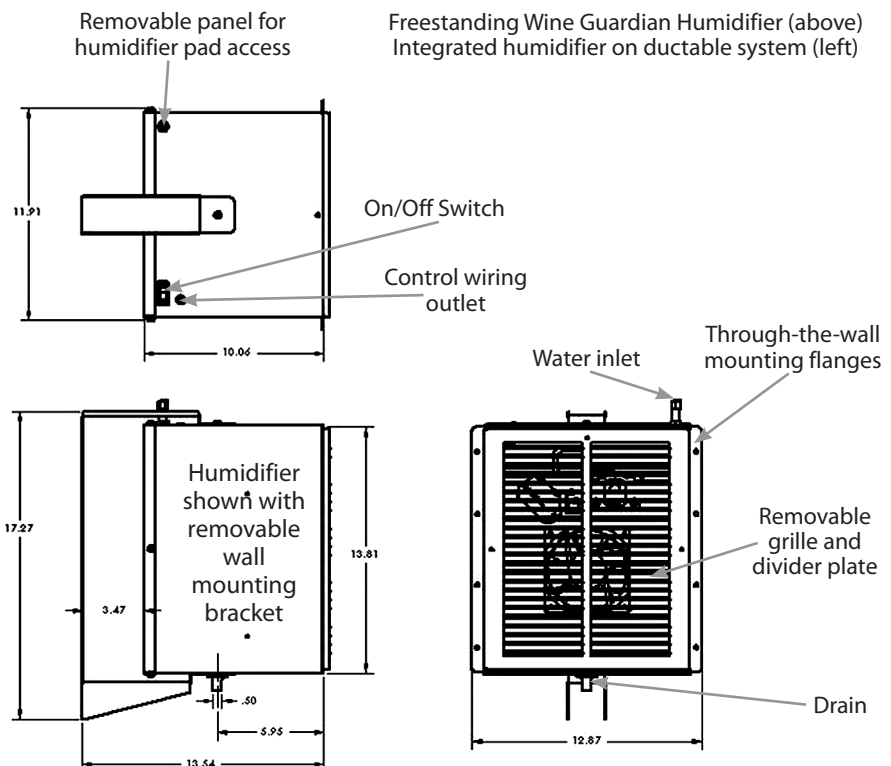

- E.&O.E. - May not be in stock at all branches, if so please allow 10 days for delivery. -
- All Prices F.O.B. Our Warehouse - Subject to Change Without Notice - All Taxes Extra -